



## Triflex BFS

- 02 Triflex BFS
- 03 System Build Up and Finish Options
- 04 System Benefits
- 06 System Data Sheet
- 12 Model Specifications
  - 12 Variant 1 - Heavy duty
  - 14 Variant 2 - Moderate duty
  - 16 Variant 3 - Light duty
- 18 Sketch Details

# Triflex BFS

## Fast curing, thick layer, waterproofing and surfacing system for walkways, balconies and terraces - 3 finish options

The Triflex BFS cold liquid applied, waterproofing and surfacing system was developed to provide the optimum combination of aesthetic and functional requirements for walkways, balconies and terraces which are not over occupied premises, e.g. cantilevered structures. With three system variants and a wide choice of colours and textures the system can be fully tailored to meet the requirements of the project.

The system is suitable for both new build and refurbishment projects and the majority of deck constructions. The systems' exceptionally rapid cure times, totally cold application and substrate compatibility (including asphalt) make it the first choice for areas where access is restricted and time on site needs to be minimised.

The heavy duty system uses our unique reinforced waterproofing technology locally to provide the optimum security for the project.



### System information:

System Build Up and Finish Options	System Benefits	System Data Sheet	Model Specifications	Sketch Details
Details of the build up of all variants of the system and the available finish options	Details of - system, environmental and quality benefits	Details of - system properties, build up, substrate compatibility, and application	Variant 1 - Heavy duty Variant 2 - Moderate duty Variant 3 - Light duty	Standard details dealing with the majority of walkway, balcony and terrace details
Page 03	Pages 4-5	Pages 6-11	Pages 12-17	Pages 18-20

For further information on how Triflex BFS can be used to solve your walkway, balcony and terrace waterproofing and surfacing problems, please contact the Triflex Technical Team on 01785 819119.

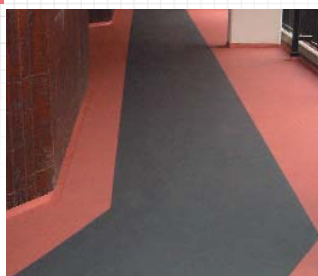

# Triflex BFS System Build Up and Finish Options

Fast curing, thick layer, waterproofing and surfacing system for walkways, balconies and terraces  
- 3 finish options

## Variant 1 - Heavy duty

### Build Up



### Finish Options



Large Grain  
Crystal Quartz with  
Pigmented Seal

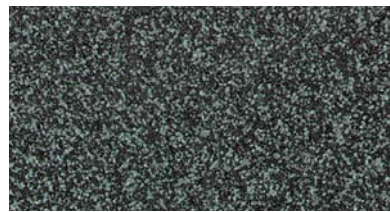

Large Grain  
Coloured Quartz  
with Clear Seal

## Variant 2 - Moderate duty

### Build Up

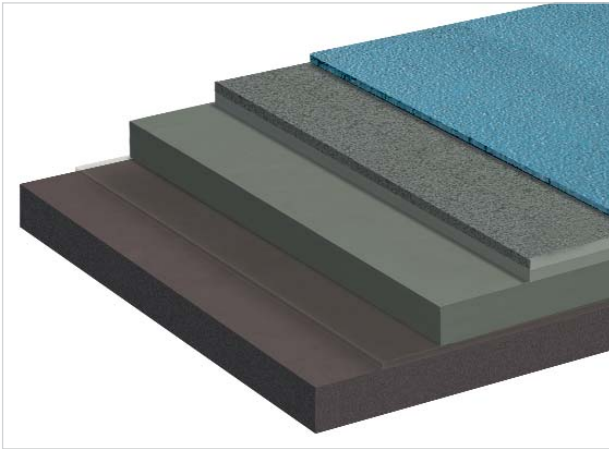

### Finish Options



Small Grain  
Crystal Quartz  
with Pigmented Seal



Small Grain  
Coloured Quartz  
with Clear Seal

## Variant 3 - Light duty

### Build Up

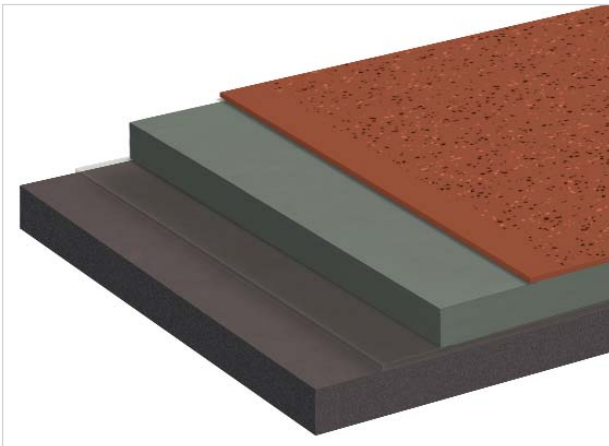

### Finish Options

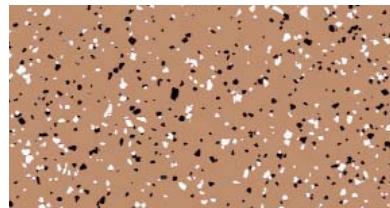

Pigmented Smooth  
Finish with Micro  
Chips

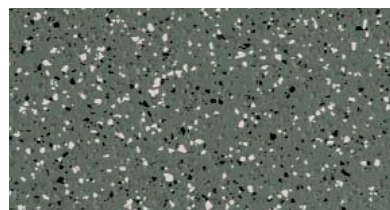

Pigmented Anti-Skid  
Finish with Micro  
Chips

**Note:** For the full colour selection please refer to pages 11 to 13

# Triflex BFS

# System Benefits

Fast curing, thick layer, waterproofing and surfacing system for walkways, balconies and terraces  
- 3 finish options

## COLOURS, TEXTURES AND AESTHETICS

- ∴ Available with three finish options to suit both functional and aesthetic requirements:
  - Variant 1 - Heavy duty: Recommended for general access, heavily trafficked walkways, balconies and terraces
  - Variant 2 - Moderate duty: Recommended for restricted access walkways, balconies and terraces
  - Variant 3 - Light duty: Recommended for private access walkways, balconies and terraces
- ∴ The wide choice of variants and further choice of finish options allows a unique combination to suit all needs

## TOTALLY COLD APPLIED WITH EXCEPTIONALLY RAPID CURE TIMES

- ∴ All elements of the system are cold applied, avoiding the risks and insurance costs associated with hot works
- ∴ Avoidance of hot works is becoming increasingly important as many clients and building insurers are specifying "100% cold" works for their properties
- ∴ Adjacent flammable materials and / or structures require no further special protection during the installation of the system
- ∴ Time on site for the contractor is minimised
- ∴ Works on site can commence immediately with no waiting time for the heating of materials
- ∴ The risk of injury to operatives from the use of hot materials is eliminated
- ∴ With its exceptionally rapid cure times, areas are rapidly waterproofed and time on site is reduced
- ∴ Access restrictions are minimised as the system achieves full mechanical properties exceptionally quickly and all layers of the system can be trafficked shortly after installation
- ∴ With exceptionally short 'rain proof' times, weather windows can be maximised to ensure the highest levels of productivity
- ∴ The contractor can leave site, confident that areas completed are totally secure

## TOUGH AND DURABLE

- ∴ The Triflex BFS system features various heavy duty build ups providing both protection to the waterproofing and a choice of textures and finish options
- ∴ The waterproofing and surfacing layers are designed to be tough and durable to withstand the specific demands of the walkway, balcony and terrace environment
- ∴ The Variant 1: Heavy duty option is designed for high levels of traffic, with either a crystal quartz, coloured quartz or basalt wearing course. The aggregate is tightly bound within the resin matrix and provides both the wearing layer and long term resistance to damage
- ∴ Unlike the more commonly available resins, Triflex resins achieve excellent inter layer adhesion, do not suffer inter layer delamination and have excellent resistance to the day to day forces imposed on walkway, balcony and terrace systems

## THICK LAYER BUILD UP

- ∴ With a finished thickness in excess of 4mm for the Variant 1 system, the Triflex BFS has exceptional durability, helps mask deck imperfections and provides a more aesthetically pleasing, easier to maintain system
- ∴ The system thickness allows profiled substrates such as brushed concrete and crimped asphalt to be overlaid without the original profile reflecting through

## OVERLAY VS STRIP AND REPLACE

- ∴ The Triflex BFS can be used for both refurbishment and new build projects
- ∴ The unique properties of the Triflex BFS allow virtually all common balcony, walkway and terrace substrates to be overlaid, including asphalt
- ∴ The ability to overlay the existing construction decreases disruption to the occupier, and reduces the risk of water ingress during the works
- ∴ Without the need to strip the existing coverings, Health and Safety is improved, time on site is minimised, the requirement for temporary waterproofing avoided, and overall costs reduced

## LOW TEMPERATURE CURING

- ∴ Works can be carried out all year round and in the majority of climatic conditions, allowing the project to be completed when required, not when dictated by the temperature

## SEAMLESS - WITH NO JOINTS SEAMS OR FIXINGS

- ∴ The seamless Triflex BFS avoids potential areas of weakness - one weak joint, seam or fixing can compromise the integrity of the whole area
- ∴ The Triflex BFS system allows the area to be completed section by section with seamless continuity and no increased risk of water ingress during the installation
- ∴ Structural details can be accommodated without the requirement for mechanical fixings and terminations which can be prone to failure

# Triflex BFS

# System Benefits

Fast curing, thick layer, waterproofing and surfacing system for walkways, balconies and terraces  
- 3 finish options

- FULLY BONDED WITH EXCELLENT INTER LAYER ADHESION**
  - ⚡ Being fully bonded, underflow of water directly beneath the membrane is prevented
  - ⚡ The inter layer adhesion of the system is generally greater than the cohesive strength of the substrate, virtually eliminating the risk of debonding or delamination

---

- UNIQUE PARTIALLY REINFORCED APPLICATION**
  - ⚡ Meaning that all details and identified areas of weakness can be safely incorporated
  - ⚡ Through incorporation of the localised reinforcement with our unique resin technology, the Triflex BFS system provides long term waterproofing security for the structure
  - ⚡ Because the system is applied as a liquid it can be shaped to suit any form, allowing even the most complex of areas to be treated in the minimum time
  - ⚡ The thixotropic liquid applied Triflex ProDetail® for the interface details allows vertical surfaces and a wide range of substrates with different coefficients of expansion to be safely incorporated into the project

---

- CHEMICAL RESISTANT**
  - ⚡ The Triflex BFS system offers high levels of chemical resistance

---

- UV RESISTANT**
  - ⚡ The Triflex BFS system is both resistant to UV degradation and through the use of UV stable inorganic pigments, retains its colour over time

---

- SIMPLE MAINTENANCE**
  - ⚡ Triflex walkway, balcony and terrace systems are designed to be low maintenance, minimising in service costs
  - ⚡ The system can be simply cleaned - refer to 'Maintenance and Care'
  - ⚡ Should additions need to be made, these can be incorporated quickly and easily

## Environmental benefits

- COMMITMENT TO THE ENVIRONMENT**
  - ⚡ The Triflex Environmental Policy is certified under DIN ISO 14001
  - ⚡ The Triflex BFS system is solvent, isocyanate and halogen free, minimising its environmental impact

## Quality benefits

- QUALITY ASSURED MANUFACTURING**
  - ⚡ As all materials are manufactured to ISO9001 quality assurance standards you can be assured of consistently high quality

---

- QUALITY DESIGN, SPECIFICATION ASSISTANCE AND SUPPORT**
  - ⚡ The Triflex Technical Team can assist in all areas of the design and specification process and provide ongoing support through to delivery of the project

---

- QUALITY INSTALLATION**
  - ⚡ Triflex walkway, balcony and terrace systems are only installed by our contracting partners who have been specially selected for their ability to provide the highest level of service to the client

# Triflex BFS

# System Data Sheet

Fast curing, thick layer, waterproofing and surfacing system for walkways, balconies and terraces  
- 3 finish options

## Properties

- Waterproof, thick layer system
- Available with the following finish options:
  - Variant 1 - Heavy duty**
    - 0.7 - 1.2mm crystal quartz with pigmented seal
    - 0.7 - 1.2mm coloured quartz with clear seal
    - 1.0 - 1.6mm basalt with Traffic Grey pigmented seal
  - Variant 2 - Moderate duty**
    - 0.4 - 0.8mm crystal quartz with pigmented seal
    - 0.3 - 0.8mm coloured quartz with clear seal
  - Variant 3 - Light duty**
    - smooth Finish with Micro Chips
    - anti-skid Finish with Micro Chips
- Seamless - with no joints, seams or fixings
- Localised reinforcement to deal with dynamic cracking and movement zones
- Flexible
- Anti-skid / Anti-slip
- Impact and abrasion resistant
- Durable - resistant to static and dynamic loads
- Totally cold applied
- Exceptionally fast curing
- Hydrolysis resistant - resistant to standing water
- Based on highly advanced PMMA technology
- Quick and easy to apply
- Compatible with a wide range of substrates
- Suitable for all common walkway, balcony and terrace constructions
- Fully bonded with excellent inter layer adhesion
- Chemical resistant
- Resistant to Chloride and Carbon Dioxide ingress
- Vapour permeable
- Low temperature curing - 0°C
- UV resistant
- Solvent free
- Isocyanate free
- Halogen free
- Fire resistant:
  - EN ISO-11925-2:2002
  - EN ISO-9239-1:2002
- Tailored design options
- 10 year materials warranty as standard
- Optional extended warranties available

## System Details - Variant 1 - Heavy duty

**Triflex Primer** - Primer for sealing of substrate and to improve adhesion.

**Triflex Deck Floor Layer** - Waterproof, self levelling surfacing layer with large grain, hard wearing crystal quartz, coloured quartz or basalt aggregate.

**Triflex Finish** - Abrasion resistant system seal coat.

## Applications

The system is suitable for the waterproofing and surfacing of walkways, balconies and terraces which are not over occupied premises e.g. cantilevered structures.

- Heavy duty applications
- Moderate duty applications
- Light duty applications

## System Details - Variant 2 - Moderate duty

**Triflex Primer** - Primer for sealing of substrate and to improve adhesion.

**Triflex Deck Floor Layer** - Waterproof, self levelling surfacing layer.

**Triflex Finish** - Seal coat fully filled with small grain, hard wearing crystal quartz or coloured quartz aggregate.

**Triflex Finish** - Abrasion resistant system seal coat.

## Applications

The system is suitable for the waterproofing and surfacing of walkways, balconies and terraces which are not over occupied premises e.g. cantilevered structures.

- Moderate duty applications
- Light duty applications

## System Details - Variant 3 - Light duty

**Triflex Primer** - Primer for sealing of substrate and to improve adhesion.

**Triflex Deck Floor Layer** - Waterproof, self levelling surfacing layer.

**Triflex Finish** - Abrasion resistant system seal coat with Micro Chips and optional Anti-Skid Granules.

## Applications

The system is suitable for the waterproofing and surfacing of walkways, balconies and terraces which are not over occupied premises e.g. cantilevered structures.

- Light duty applications

# Triflex BFS

# System Data Sheet

Fast curing, thick layer, waterproofing and surfacing system for walkways, balconies and terraces  
- 3 finish options

## System Build Ups

### Variant 1 - Heavy duty

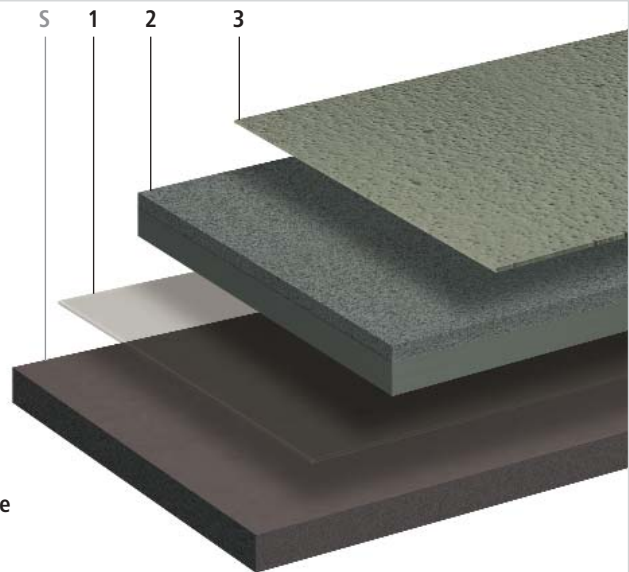
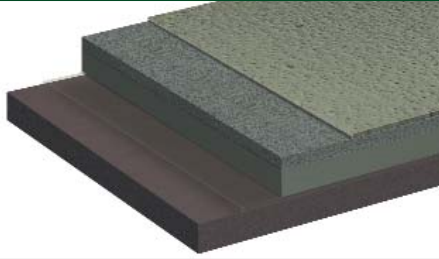

- S Substrate
- 1 Triflex Primer
- 2 Triflex Deck Floor Layer - fully filled with large grain aggregate
- 3 Triflex Finish

### Variant 2 - Moderate duty

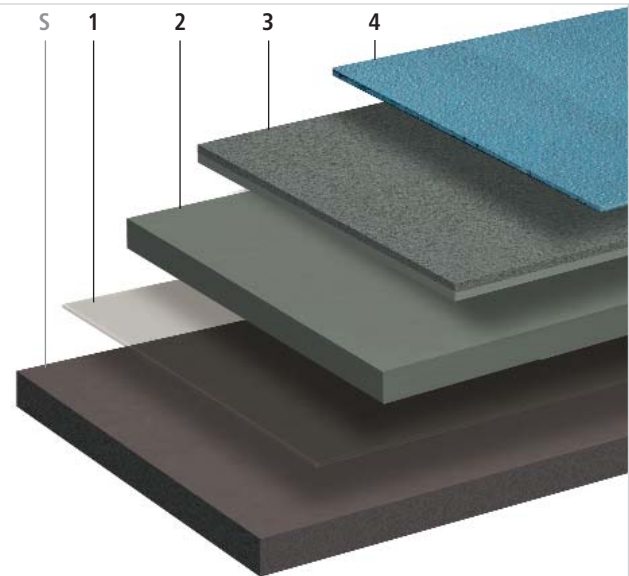
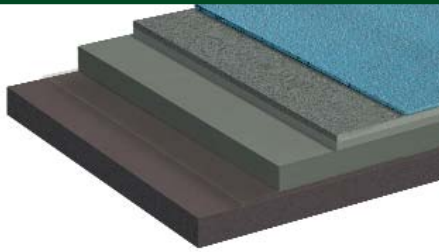

- S Substrate
- 1 Triflex Primer
- 2 Triflex Deck Floor Layer
- 3 Triflex Finish - fully filled with small grain aggregate
- 4 Triflex Finish

### Variant 3 - Light duty

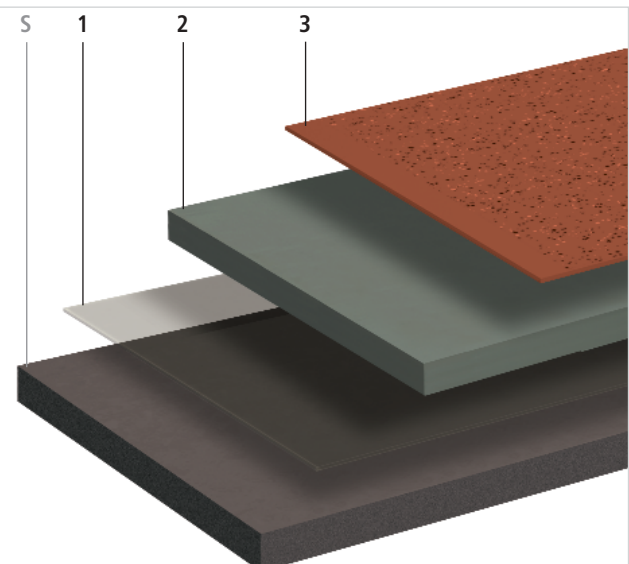
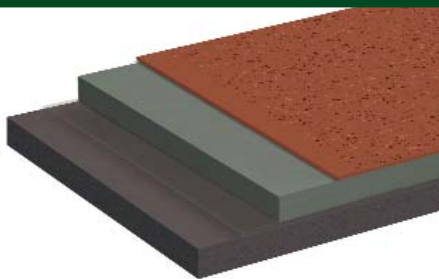

- S Substrate
- 1 Triflex Primer
- 2 Triflex Deck Floor Layer
- 3 Triflex Finish / Anti-Skid Finish with Micro Chips

# Triflex BFS

# System Data Sheet

## Substrate preparation and priming

Substrate	Preparation Notes	Priming	
		Triflex BFS main area	Triflex ProDetail <sup>®</sup> for details
Asphalt	1	Triflex Cryl Primer 222	Triflex Cryl Primer 222
Hot Rolled Asphalt (HRA)	1 / 8	Triflex Cryl Primer 222	Triflex Cryl Primer 222
Stone Mastic Asphalt (SMA)	1 / 8	Triflex Cryl Primer 222	Triflex Cryl Primer 222
Felt	2	N/A details only	No primer required
SBS Felt	2	N/A details only	No primer required
APP Felt	3	N/A details only	No primer required
Concrete / Screed	1 / 6	Triflex Cryl Primer 276	Triflex Cryl Primer 276
Lightweight concrete	1 / 6	Triflex Cryl Primer 276	Triflex Cryl Primer 276
Polymer modified concrete repair materials	1 / 6	Triflex Cryl Primer 276	Triflex Cryl Primer 276
Steel	4	No primer required	No primer required
Galvanised steel	4	No primer required	No primer required
Stainless steel	4	N/A details only	No primer required
Aluminium	4	N/A details only	No primer required
Copper	4	N/A details only	No primer required
Zinc	4	N/A details only	No primer required
Lead	4	N/A details only	No primer required
Glass	4	N/A details only	No primer required
Timber	2	N/A details only	Triflex Cryl Primer 276
Plastics (sheets, coatings, mouldings)			
CPE	4	N/A details only	No primer required
EVA	2	N/A details only	No primer required
PIB	2	N/A details only	No primer required
PVC-P, nB	4	N/A details only	No primer required
UPVC	4	N/A details only	No primer required
GRP	4	N/A details only	No primer required
PU (polyurethane)	5 / 7	No primer required	No primer required
PMMA (acrylic)	5 / 7	No primer required	No primer required
UP (polyester)	5 / 7	No primer required	No primer required
EP (epoxy)	5 / 7	No primer required	No primer required

For other substrates, consult Triflex (UK) Limited for required preparation methods and priming.

### Notes:

- 1 = Scarify, grind or lightly bead blast
- 2 = Clean thoroughly
- 3 = Liquefy surface by application of heat and immediately top with quartz
- 4 = Rub down thoroughly with Triflex Cleaners, and abrade / grind metals and hard plastics to achieve a roughened surface  
(steel must be ground or blasted to bright metal – where all rust cannot be practically removed an approved active anti-corrosion primer may be used)
- 5 = Lightly abrade and carry out an adhesion test
- 6 = The equilibrium moisture content of cementitious materials must not exceed 6% or 75% RH. Where moisture levels are in excess of these values refer to Triflex Pox R103
- 7 = Subject to testing of insitu material and approval by Triflex (UK) Limited
- 8 = For HRA and SMA, increase primer consumption by 50% and use maximum practical catalyst (minimum 6%)

Where there are any doubts as to adhesion, carry out an adhesion test.

# Triflex BFS

# System Data Sheet

Fast curing, thick layer, waterproofing and surfacing system for walkways, balconies and terraces  
- 3 finish options

## Substrate Assessment

In all cases the condition and stability of the underlying substrate should be assessed prior to the commencement of work. See Substrate Testing section. Concrete structures should be designed in accordance with BS8110/CP110.

## Substrate Preparation

Refer to substrate preparation and priming schedule.

Generally:

Remove existing paint and finishes etc. by grinding.

Ensure that the prepared surface is clean, dry and free from dust, laitance, grease, oil and any other contaminants.

## Priming

Refer to substrate preparation and priming schedule.

### Triflex Cryl Primer 222:

Apply with a lambswool roller (0.4kg/m<sup>2</sup> min.)

Rainproof after approx. 30 minutes.

Can be walked upon/next coat applied after approx. 45 minutes.

### Triflex Cryl Primer 276:

Apply with a lambswool roller (0.4kg/m<sup>2</sup> min.)

Rainproof after approx. 30 minutes.

Can be walked upon/next coat applied after approx. 45 minutes.

**Note:** For new cementitious materials where it is not practical to allow the substrate to hydrate to below 6% equilibrium moisture content and 75% RH, or for existing cementitious substrates with higher levels of moisture, Triflex Pox R103 can be used where the equilibrium moisture content is less than 10%.

### Triflex Pox R103:

Apply with a lambswool roller (0.5kg/m<sup>2</sup> min.)

Can be walked on after approx. 8 hours.

Next coat applied after approx. 18 hours.

Able to withstand stress after approx. 24 hours.

## Surface Repairs and Filling

Cut out blisters and repair all minor indentations with scratch coat of Triflex Cryl RS 233 or Triflex Cryl Paste. Allow to dry for a minimum of 1 hour.

Fill all voids in vertical surfaces and at upstand transitions with Triflex Cryl Paste and allow to dry for a minimum of 1 hour.

Larger indentations can be filled with Triflex Cryl RS 240 (cementitious substrates), Triflex Cryl Mortar or Triflex Cryl Paste Mortar (non-cementitious substrates).

## Dynamic Cracks and Dayjoints

Remove any existing filler material and fill with Triflex Cryl RS 233.

Apply Triflex Cryl R 210 (1.5kg/m<sup>2</sup> min.) with a lambswool roller.

Roll a strip of Triflex 110g Reinforcement into the wet resin, pressing trapped air free using the lambswool roller, ensuring a minimum 50mm overlap between the reinforcement sheets.

Apply Triflex Cryl R 210 (1.0kg/m<sup>2</sup> min.) wet on wet to ensure full saturation of the fleece. Allow to dry for a minimum of 1 hour.

Minimum fleece overlap either side of dynamic crack/dayjoint - 75mm.

**Note:** Identification of Dynamic Cracks should include a survey of the soffit (where visible).

## Interface Details

Apply in accordance with standard and project specific sketch details.

### General Details:

Apply Triflex ProDetail® (2.0 kg/m<sup>2</sup> min.) with a lambswool roller.

Roll a strip of Triflex 110g Reinforcement into the wet resin, pressing trapped air free using the lambswool roller, ensuring a minimum 50mm overlap between the reinforcement sheets.

Apply Triflex ProDetail® (1.0 kg/m<sup>2</sup> min.) wet on wet to ensure full saturation of the fleece.

Rainproof after approx. 30 minutes.

Can be walked on/next coat applied after approx. 45 minutes.

### Complex Details:

Where due to access restrictions, or complexity of the detail, Triflex ProDetail® is not practical:

Apply Triflex Cryl R 295 fibre reinforced resin (1.5 kg/m<sup>2</sup> min.) with a brush and allow to cure for a minimum of 45 minutes.

Apply a further layer of Triflex Cryl R 295 fibre reinforced resin (1.5 kg/m<sup>2</sup> min.) by brush.

Rainproof after approx. 30 minutes.

Can be walked upon/next coat applied after approx. 45 minutes.

**Note:** Where details may be subject to mechanical damage, consult Triflex (UK) Limited for mechanical protection solutions.

## Main Area

### Variant 1 - Heavy duty

#### Waterproofing and surfacing layer:

Apply Triflex Cryl RS 233 (4.0kg/m<sup>2</sup> min.) by trowel.

Embed into the wet Triflex Cryl RS 233 a full cover of crystal quartz (0.7 - 1.2mm), coloured quartz (0.7 - 1.2mm), or basalt (1.0 - 1.6mm) (5.0kg/m<sup>2</sup>) approx. Allow to dry for a minimum of 2 hours, sweep away excess aggregate and vacuum clean.

Rainproof after approx. 30 minutes.

Can be walked upon after approx. 1 hour.

Next coat applied after approx. 2 hours.

#### Finish:

##### Interface Details

Apply Triflex Cryl Finish 205 (0.5kg/m<sup>2</sup> min.) using a lambswool roller.

Rainproof after approx. 30 minutes.

Can be walked upon after approx. 1 hour.

**Note:** For interface details in excess of 250mm high, use Triflex Cryl Finish 205 Thixo.

#### Main Area

Crystal quartz / basalt systems (pigmented seal) - Apply Triflex Cryl Finish 205 (0.65kg/m<sup>2</sup> min.), (0.8kg/m<sup>2</sup> min.) if over basalt) using a lambswool roller and remove excess material / level with a dry lambswool roller.

Coloured quartz systems (clear seal) - Apply Triflex Cryl Finish 202 (0.65kg/m<sup>2</sup> min.) using a lambswool roller and remove excess material / level with a dry lambswool roller.

Rainproof after approx. 30 minutes.

Can be walked upon after approx. 1 hour.

Can be subjected to loads after approx. 3 hours.

# Triflex BFS

# System Data Sheet

Fast curing, thick layer, waterproofing and surfacing system for walkways, balconies and terraces  
- 3 finish options

## Variant 2 - Moderate duty

### Waterproofing layer:

Apply Triflex Cryl RS 233 (4.0kg/m<sup>2</sup> min.) by trowel.

Rainproof after approx. 30 minutes.

Can be walked upon after approx. 1 hour.

Next coat applied after approx. 2 hours.

### Surfacing layer:

Apply Triflex Cryl Finish 205 (0.6kg/m<sup>2</sup> min.) with a lambswool roller. Embed into the wet Triflex Cryl Finish 205 a full cover of crystal quartz (0.4 - 0.8mm) or coloured quartz (0.3 - 0.8mm) (5.0kg/m<sup>2</sup>) approx.

Allow to dry for a minimum of 2 hours, sweep away excess aggregate and vacuum clean.

Rainproof after approx. 30 minutes.

Can be walked upon after approx. 1 hour.

Next coat applied after approx. 2 hours.

### Finish:

#### Interface Details

Apply Triflex Cryl Finish 205 (0.5kg/m<sup>2</sup> min.) using a lambswool roller.

Rainproof after approx. 30 minutes.

Can be walked upon after approx. 1 hour.

**Note:** For interface details in excess of 250mm high, use Triflex Cryl Finish 205 Thixo.

### Main Area

Crystal quartz systems (pigmented seal) - Apply Triflex Cryl Finish 205 (0.5kg/m<sup>2</sup> min.) using a lambswool roller and remove excess material / level with a dry lambswool roller.

Coloured quartz systems (clear seal) - Apply Triflex Cryl Finish 202 (0.5kg/m<sup>2</sup> min.) using a lambswool roller and remove excess material / level with a dry lambswool roller.

Rainproof after approx. 30 minutes.

Can be walked upon after approx. 1 hour.

Can be subjected to loads after approx. 3 hours.

## Variant 3 - Light duty

### Waterproofing and surfacing layer:

Apply Triflex Cryl RS 233 (5.0kg/m<sup>2</sup> min.) by trowel.

Rainproof after approx. 30 minutes.

Can be walked upon after approx. 1 hour.

Next coat applied after approx. 2 hours.

### Finish:

#### Interface Details

Apply Triflex Cryl Finish 205 (0.5kg/m<sup>2</sup> min.) using a lambswool roller. Apply Triflex Micro Chips into the wet Triflex Cryl Finish 205 by hand or hopper spray gun. Allow to dry for a minimum of 1 hour and remove excess Micro Chips.

Rainproof after approx. 30 minutes.

Can be walked upon after approx. 1 hour.

**Note:** For interface details in excess of 250mm high, use Triflex Cryl Finish 205 Thixo.

### Main Area

Apply Triflex Cryl Finish 205 (0.5kg/m<sup>2</sup> min.) / Triflex Cryl Finish 205 Anti-Skid (0.35kg/m<sup>2</sup> min.) using a lambswool roller. Apply Triflex Micro Chips into the wet Triflex Finish by hand or hopper spray gun. Allow to dry for a minimum of 1 hour and remove excess Micro Chips.

Rainproof after approx. 30 minutes.

Can be walked upon after approx. 1 hour.

Can be subjected to loads after approx. 3 hours.

## Expansion Joints

Consult Triflex (UK) Limited for confirmation of design details required.

## Interruptions During Works

If work is interrupted for more than 12 hours, use Triflex Cleaner to clean and reactivate the transition area.

Evaporation time: at least 20 minutes - overlay within 60 minutes.

For reinforced details, the subsequent waterproofing layers must overlap by at least 100 mm, including the Reinforcement.

## System Components

Please refer to the appropriate Product Data Sheet for details about areas of application/application conditions/mixing instructions (available on request):

**Triflex Cryl Primer 222**

**Triflex Cryl Primer 276**

**Triflex Pox R103**

**Triflex Cryl Paste**

**Triflex Cryl RS 240**

**Triflex Cryl Mortar**

**Triflex Cryl Paste Mortar**

**Triflex Cryl R210**

**Triflex 110g Reinforcement**

**Triflex ProDetail®**

**Triflex Cryl R 295**

**Triflex Cryl RS 233**

**Triflex Cryl Finish 205**

**Triflex Cryl Finish 202**

**Triflex Cryl Finish 205 Anti-Skid**

**Triflex Micro Chips**

## Quality Standard

All products are manufactured to ISO 9001.

# Triflex BFS

# System Data Sheet

Fast curing, thick layer, waterproofing and surfacing system for walkways, balconies and terraces  
- 3 finish options

## Substrate Testing

Prior to the commencement of work the Contractor must check and only proceed if he has satisfied the following requirements.

Dimensional stability: All factors which may affect the subsequent performance of the system e.g. failed structural elements etc. must be repaired.

Hardness: All concrete substrates, concrete repair materials, screeds and mortars shall be cured and allowed to achieve a minimum hardness of 25N/mm<sup>2</sup>.

Moisture: Prior to overlay with Triflex systems, the equilibrium moisture content of the substrate must not exceed 6% and 75% RH. For cementitious substrates with higher levels of moisture (less than 10% equilibrium) refer to Triflex Pox R103.

Adhesion: Trial areas to be prepared to ensure that the System achieves a minimum bond to the substrate of:

Concrete, concrete repair materials, screeds and mortars: 1.5N/mm<sup>2</sup>

All other substrates: 0.8N/mm<sup>2</sup>

## Health and Safety

Refer to product Health and Safety data prior to using the materials.

## Coverage Rates

The coverage rates given are guidelines based on smooth, level substrates. Allowances must be made if the substrate is uneven, rough or porous.

## Drying Times

The drying times stated are at +20°C and are dependent upon weather conditions.

## Important Notes

It is the Contractors' responsibility to ensure that the substrate is suitable and that the system is applied in all areas in accordance with Technical Data Sheets and Application Guidelines in force at the time.

The advice we can provide on the application of our products is based on extensive development work as well as many years of experience and is given to the best of our knowledge. However, the wide variety of requirements for a building under the most diverse conditions mean that it is necessary for the Contractor to test the product for suitability in any given case. We reserve the right to make alterations in keeping with technical developments or improvements.

# Triflex BFS

# Model specification

Fast curing, thick layer, waterproofing and surfacing system for walkways, balconies and terraces

## Variant 1 - Heavy Duty

### J31 Liquid Applied Waterproof Roof Coatings

To be read with Preliminaries / General Conditions.

### Liquid Applied Waterproof Roof Coating Reference

#### Triflex BFS - Variant 1

Manufacturer:

Triflex (UK) Limited

Whitebridge Way

Stone

Staffordshire

ST15 8GH

Tel: +44 (0) 1785 819119

Fax: +44 (0) 1785 819960

E-mail: info@triflex.co.uk

Web: www.triflex.co.uk

### Generally

Apply Triflex BFS system fully in accordance with Manufacturer's System Data Sheet (Appendix ), standard Sketch Details (Appendix ), and project specific Sketch Details (Appendix ).

### Substrate Assessment

Assess substrate in accordance with Triflex BFS System Data Sheet.

### Substrate Preparation

Prepare substrate in accordance with Triflex BFS System Data Sheet.

### Priming

Apply Triflex primer in accordance with Triflex BFS System Data Sheet.

**Primer reference:** Triflex Cryl Primer 222 / Triflex Cryl Primer 276 / Triflex Pox R103.

### Surface Repairs and Filling

Repair and fill surface in accordance with Triflex BFS System Data Sheet.

**Filling reference:** Triflex Cryl RS233 / Triflex Cryl Paste / Triflex Cryl RS240 / Triflex Cryl Mortar / Triflex Cryl Paste Mortar.

### Dynamic Cracks and Dayjoints

Treat dynamic cracks and dayjoints in accordance with Triflex BFS System Data Sheet.

**Filling reference:** Triflex Cryl RS233.

**Overbanding reference:** Triflex Cryl R210 with 110g Reinforcement.

### Interface Details

Apply interface details in accordance with Triflex BFS System Data Sheet, standard Sketch Details and project specific Sketch Details.

**General details reference:** Triflex ProDetail® with 110g Reinforcement.

**Complex details reference:** Triflex Cryl R295.

### Main Area

#### Waterproofing and surfacing layer:

Apply waterproofing and surfacing layer to main deck area in accordance with Triflex BFS System Data Sheet (Variant 1 – Heavy duty).

**Waterproofing and surfacing layer reference:** Triflex Cryl RS233.

**Aggregate reference:** crystal quartz / coloured quartz / basalt.

**Coloured quartz colour mix reference:** INSERT.

#### Finish:

Apply finish in accordance with Triflex BFS System Data Sheet (Variant 1 – Heavy duty).

**Finish reference:** Triflex Cryl Finish 205 / Triflex Cryl Finish 202.

**Finish colour references:** INSERT.

### Installation

The works shall be executed by a Triflex Approved Contracting Partner licensed to install Triflex walkway, balcony and terrace waterproofing, surfacing and protection systems.

# Triflex BFS

# Model specification

Fast curing, thick layer, waterproofing and surfacing system for walkways, balconies and terraces

## Variant 1 - Heavy Duty

### Required System Properties

- Waterproof, thick layer system (>4mm Dry Film Thickness)
- Available with the following finish options:
  - Variant 1 - Heavy duty
    - 0.7 - 1.2mm crystal quartz with pigmented seal
    - 0.7 - 1.2mm coloured quartz with clear seal
    - 1.0 - 1.6mm basalt with Traffic Grey pigmented seal
- Seamless - with no joints, seams or fixings
- Localised reinforcement to deal with dynamic cracking and movement zones
- Flexible
- Anti-skid
- Impact and abrasion resistant
- Durable - resistant to static and dynamic loads
- Totally cold applied
- Exceptionally fast curing
- Hydrolysis resistant - resistant to standing water
- Based on highly advanced PMMA technology
- Quick and easy to apply
- Compatible with a wide range of substrates
- Suitable for all common walkway, balcony and terrace constructions
- Fully bonded with excellent inter layer adhesion
- Chemical resistant
- Resistant to Chloride and Carbon Dioxide ingress
- Vapour permeable
- Low temperature curing - 0°C
- UV resistant
- Solvent free
- Isocyanate free
- Halogen free
- Fire resistant:
  - EN ISO-11925-2:2002
  - EN ISO-9239-1:2002
- Tailored design options
- 10 year materials warranty as standard
- Optional extended warranties available

### General Notes

The Triflex BFS System Data Sheet, standard Sketch Details and project specific Sketch Details are to be read as an integral part of this specification.

The Triflex Approved Contracting Partner is to install all details to comply with the Triflex BFS standard Sketch Details, any project specific Sketch Details and Triflex project specific recommendations. Should any detail arise where the treatment is not clear, the Contractor must seek advice and approval from Triflex (UK) Limited prior to commencing the works.

It is the Contractor's responsibility to ensure that the substrate is suitable and that the system is applied in all areas in accordance with System Data Sheets and Application Guidelines in force at the time.

### Notes to Specifiers

We recommend that for all walkway, balcony and terrace projects, the actual specification clauses for the Triflex waterproofing, surfacing and protection systems are prepared by the Triflex Technical Team.

This information can then be provided in a text format for insertion into Word and other documents.

# Triflex BFS

# Model specification

Fast curing, thick layer, waterproofing and surfacing system for walkways, balconies and terraces

## Variant 2 - Moderate Duty

### J31 Liquid Applied Waterproof Roof Coatings

To be read with Preliminaries / General Conditions.

### Liquid Applied Waterproof Roof Coating Reference

#### Triflex BFS - Variant 2

Manufacturer:

Triflex (UK) Limited

Whitebridge Way

Stone

Staffordshire

ST15 8GH

Tel: +44 (0) 1785 819119

Fax: +44 (0) 1785 819960

E-mail: [info@triflex.co.uk](mailto:info@triflex.co.uk)

Web: [www.triflex.co.uk](http://www.triflex.co.uk)

### Generally

Apply Triflex BFS system fully in accordance with Manufacturer's System Data Sheet (Appendix ), standard Sketch Details (Appendix ), and project specific Sketch Details (Appendix ).

### Substrate Assessment

Assess substrate in accordance with Triflex BFS System Data Sheet.

### Substrate Preparation

Prepare substrate in accordance with Triflex BFS System Data Sheet.

### Priming

Apply Triflex primer in accordance with Triflex BFS System Data Sheet.

**Primer reference:** Triflex Cryl Primer 222 / Triflex Cryl Primer 276 / Triflex Pox R103.

### Surface Repairs and Filling

Repair and fill surface in accordance with Triflex BFS System Data Sheet.

**Filling reference:** Triflex Cryl RS233 / Triflex Cryl Paste / Triflex Cryl RS240 / Triflex Cryl Mortar / Triflex Cryl Paste Mortar.

### Dynamic Cracks and Dayjoints

Treat dynamic cracks and dayjoints in accordance with Triflex BFS System Data Sheet.

**Filling reference:** Triflex Cryl RS233.

**Overbanding reference:** Triflex Cryl R210 with 110g Reinforcement.

### Interface Details

Apply interface details in accordance with Triflex BFS System Data Sheet, standard Sketch Details and project specific Sketch Details.

**General details reference:** Triflex ProDetail® with 110g Reinforcement.

**Complex details reference:** Triflex Cryl R295.

### Main Area

#### Waterproofing layer:

Apply waterproofing layer to main deck area in accordance with Triflex BFS System Data Sheet (Variant 2 - Moderate duty).

**Waterproofing reference:** Triflex Cryl RS233.

#### Surfacing layer:

Apply surfacing layer to main deck area in accordance with Triflex BFS System Data Sheet (Variant 2 - Moderate duty).

**Surfacing layer reference:** Triflex Cryl Finish 205.

**Aggregate reference:** crystal quartz / coloured quartz.

**Coloured quartz colour mix reference:** INSERT.

#### Finish:

Apply finish in accordance with Triflex BFS System Data Sheet (Variant 2 - Moderate duty).

**Finish reference:** Triflex Cryl Finish 205 / Triflex Cryl Finish 202.

**Finish colour references:** INSERT.

### Installation

The works shall be executed by a Triflex Approved Contracting Partner licensed to install Triflex walkway, balcony and terrace waterproofing, surfacing and protection systems.

# Triflex BFS

# Model specification

Fast curing, thick layer, waterproofing and surfacing system for walkways, balconies and terraces

## Variant 2 - Moderate Duty

### Required System Properties

- Waterproof, thick layer system
- Available with the following finish options:
  - Variant 2 - Moderate duty
    - 0.4 - 0.8mm crystal quartz with pigmented seal
    - 0.7 - 1.2mm coloured quartz with clear seal
    - 0.3 - 0.8mm coloured quartz with clear seal
- Seamless - with no joints, seams or fixings
- Localised reinforcement to deal with dynamic cracking and movement zones
- Flexible
- Anti-skid
- Impact and abrasion resistant
- Durable - resistant to static and dynamic loads
- Totally cold applied
- Exceptionally fast curing
- Hydrolysis resistant - resistant to standing water
- Based on highly advanced PMMA technology
- Quick and easy to apply
- Compatible with a wide range of substrates
- Suitable for all common walkway, balcony and terrace constructions
- Fully bonded with excellent inter layer adhesion
- Chemical resistant
- Resistant to Chloride and Carbon Dioxide ingress
- Vapour permeable
- Low temperature curing - 0°C
- UV resistant
- Solvent free
- Isocyanate free
- Halogen free
- Fire resistant:
  - EN ISO-11925-2:2002
  - EN ISO-9239-1:2002
- Tailored design options
- 10 year materials warranty as standard
- Optional extended warranties available

### General Notes

The Triflex BFS System Data Sheet, standard Sketch Details and project specific Sketch Details are to be read as an integral part of this specification.

The Triflex Approved Contracting Partner is to install all details to comply with the Triflex BFS standard Sketch Details, any project specific Sketch Details and Triflex project specific recommendations. Should any detail arise where the treatment is not clear, the Contractor must seek advice and approval from Triflex (UK) Limited prior to commencing the works.

It is the Contractor's responsibility to ensure that the substrate is suitable and that the system is applied in all areas in accordance with System Data Sheets and Application Guidelines in force at the time

### Notes to Specifiers

We recommend that for all walkway, balcony and terrace projects, the actual specification clauses for the Triflex waterproofing, surfacing and protection systems are prepared by the Triflex Technical Team.

This information can then be provided in a text format for insertion into Word and other documents.

# Triflex BFS

# Model specification

Fast curing, thick layer, waterproofing and surfacing system for walkways, balconies and terraces

## Variant 3 - Light Duty

### J31 Liquid Applied Waterproof Roof Coatings

To be read with Preliminaries / General Conditions.

### Liquid Applied Waterproof Roof Coating Reference

#### Triflex BFS - Variant 3

Manufacturer:

Triflex (UK) Limited

Whitebridge Way

Stone

Staffordshire

ST15 8GH

Tel: +44 (0) 1785 819119

Fax: +44 (0) 1785 819960

E-mail: [info@triflex.co.uk](mailto:info@triflex.co.uk)

Web: [www.triflex.co.uk](http://www.triflex.co.uk)

### Generally

Apply Triflex BFS system fully in accordance with Manufacturer's System Data Sheet (Appendix ), standard Sketch Details (Appendix ), and project specific Sketch Details (Appendix ).

### Substrate Assessment

Assess substrate in accordance with Triflex BFS System Data Sheet.

### Substrate Preparation

Prepare substrate in accordance with Triflex BFS System Data Sheet.

### Priming

Apply Triflex primer in accordance with Triflex BFS System Data Sheet.

**Primer reference:** Triflex Cryl Primer 222 / Triflex Cryl Primer 276 / Triflex Pox R103.

### Surface Repairs and Filling

Repair and fill surface in accordance with Triflex BFS System Data Sheet.

**Filling reference:** Triflex Cryl RS233 / Triflex Cryl Paste / Triflex Cryl RS240 / Triflex Cryl Mortar / Triflex Cryl Paste Mortar.

### Dynamic Cracks and Dayjoints

Treat dynamic cracks and dayjoints in accordance with Triflex BFS System Data Sheet.

**Filling reference:** Triflex Cryl RS233.

**Overbanding reference:** Triflex Cryl R210 with 110g Reinforcement.

### Interface Details

Apply interface details in accordance with Triflex BFS System Data Sheet, standard Sketch Details and project specific Sketch Details.

**General details reference:** Triflex ProDetail® with 110g Reinforcement.

**Complex details reference:** Triflex Cryl R295.

### Main Area

#### Waterproofing and surfacing layer:

Apply waterproofing and surfacing layer to main deck area in accordance with Triflex BFS System Data Sheet (Variant 3 - Light duty).

**Waterproofing and surfacing reference:** Triflex Cryl RS233.

#### Finish:

Apply finish in accordance with Triflex BFS System Data Sheet (Variant 3 - Light Duty).

**Finish reference:** Triflex Cryl Finish 205 / Triflex Cryl Finish 205 Anti-Skid.

**Finish colour references:** INSERT.

**Decorative anti-slip topping reference:** Triflex Micro Chips.

### Installation

The works shall be executed by a Triflex Approved Contracting Partner licensed to install Triflex walkway, balcony and terrace waterproofing, surfacing and protection systems.

# Triflex BFS

# Model specification

Fast curing, thick layer, waterproofing and surfacing system for walkways, balconies and terraces

## Variant 3 - Light Duty

### Required System Properties

- Waterproof, thick layer system
- Available with the following finish options:  
Variant 3 - Light duty
  - smooth Finish with Micro Chips
  - anti-skid Finish with Micro Chips
- Seamless - with no joints, seams or fixings
- Localised reinforcement to deal with dynamic cracking and movement zones
- Flexible
- Anti-slip
- Impact and abrasion resistant
- Durable - resistant to static and dynamic loads
- Totally cold applied
- Exceptionally fast curing
- Hydrolysis resistant - resistant to standing water
- Based on highly advanced PMMA technology
- Quick and easy to apply
- Compatible with a wide range of substrates
- Suitable for all common walkway, balcony and terrace constructions
- Fully bonded with excellent inter layer adhesion
- Chemical resistant
- Resistant to Chloride and Carbon Dioxide ingress
- Vapour permeable
- Low temperature curing - 0° c
- UV resistant
- Solvent free
- Isocyanate free
- Halogen free
- Fire resistant:
  - EN ISO-11925-2:2002
  - EN ISO-9239-1:2002
- Tailored design options
- 10 year materials warranty as standard
- Optional extended warranties available

### General Notes

The Triflex BFS System Data Sheet, standard Sketch Details and project specific Sketch Details are to be read as an integral part of this specification.

The Triflex Approved Contracting Partner is to install all details to comply with the Triflex BFS standard Sketch Details, any project specific Sketch Details and Triflex project specific recommendations. Should any detail arise where the treatment is not clear, the Contractor must seek advice and approval from Triflex (UK) Limited prior to commencing the works.

It is the Contractor's responsibility to ensure that the substrate is suitable and that the system is applied in all areas in accordance with System Data Sheets and Application Guidelines in force at the time.

### Notes to Specifiers

We recommend that for all walkway, balcony and terrace projects, the actual specification clauses for the Triflex waterproofing, surfacing and protection systems are prepared by the Triflex Technical Team.

This information can then be provided in a text format for insertion into Word and other documents.

# Triflex BFS

# Sketch Details

## Detail interface: Variant 1 - Heavy duty

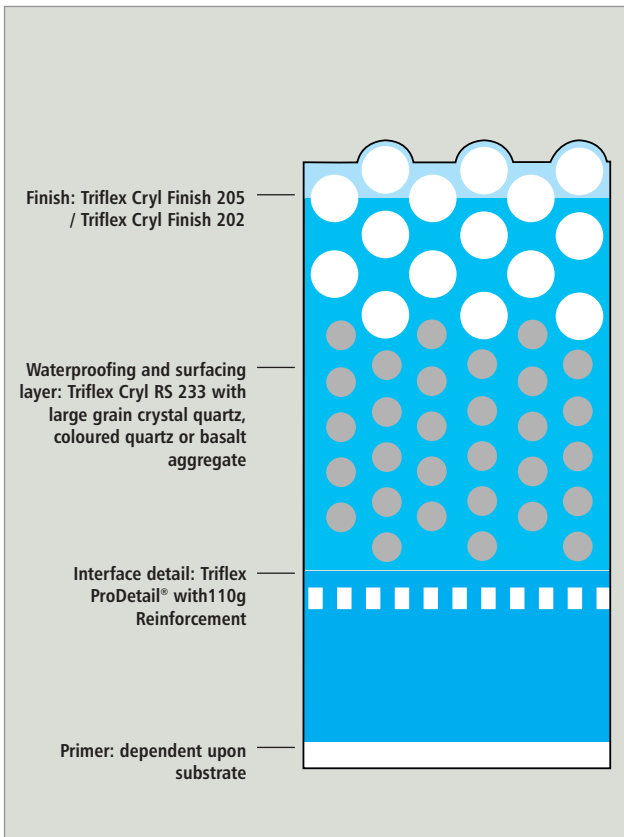

## Detail interface: Variant 2 - Moderate duty

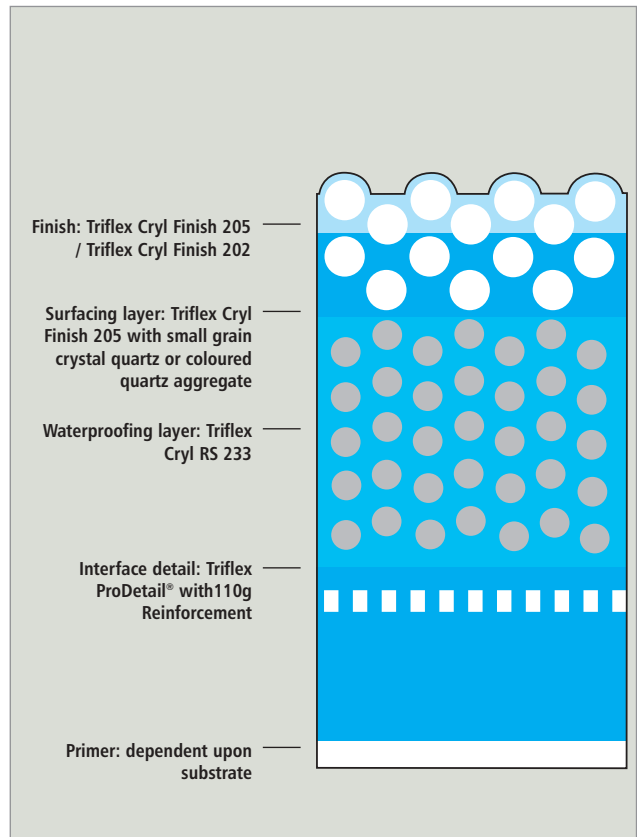

## Detail interface: Variant 3 - Light duty

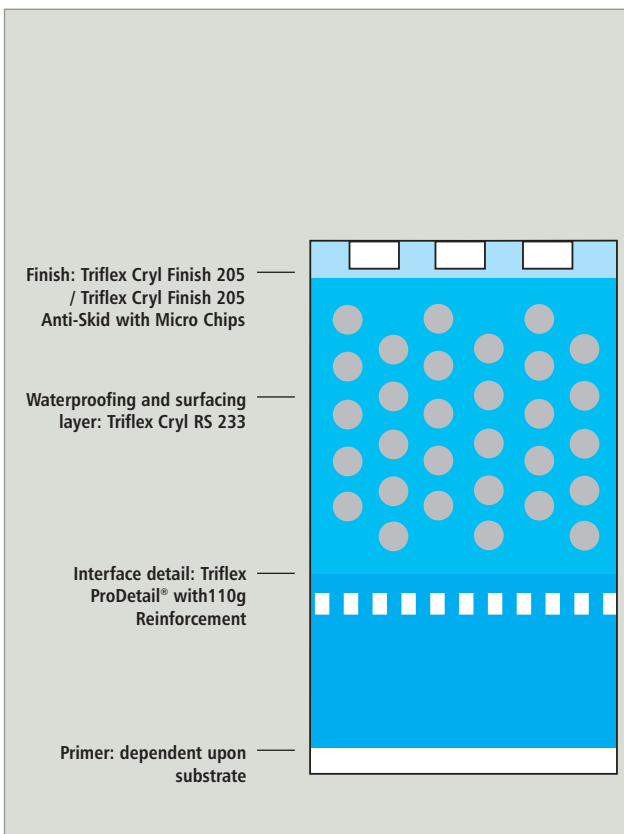

# Triflex BFS

# Sketch Details

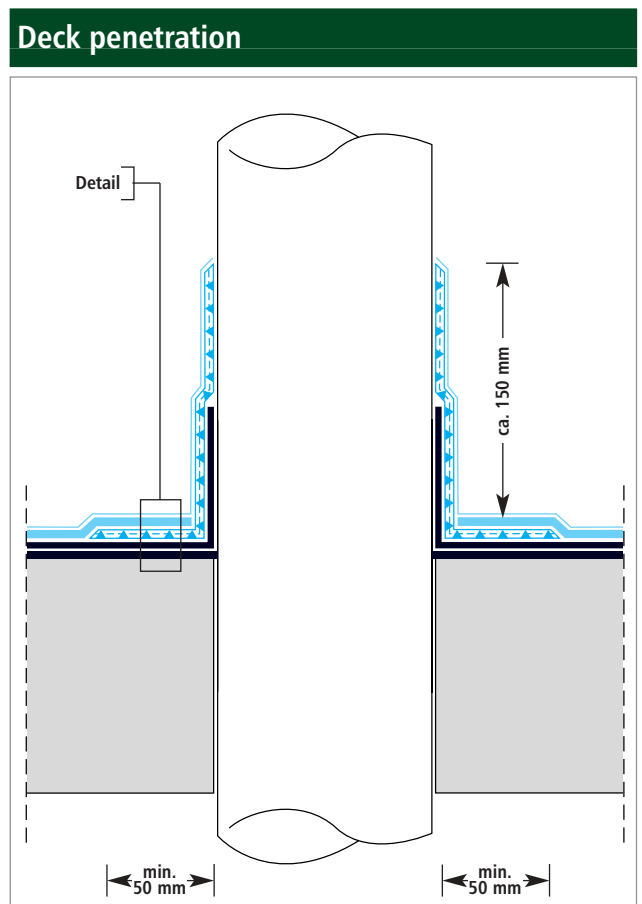
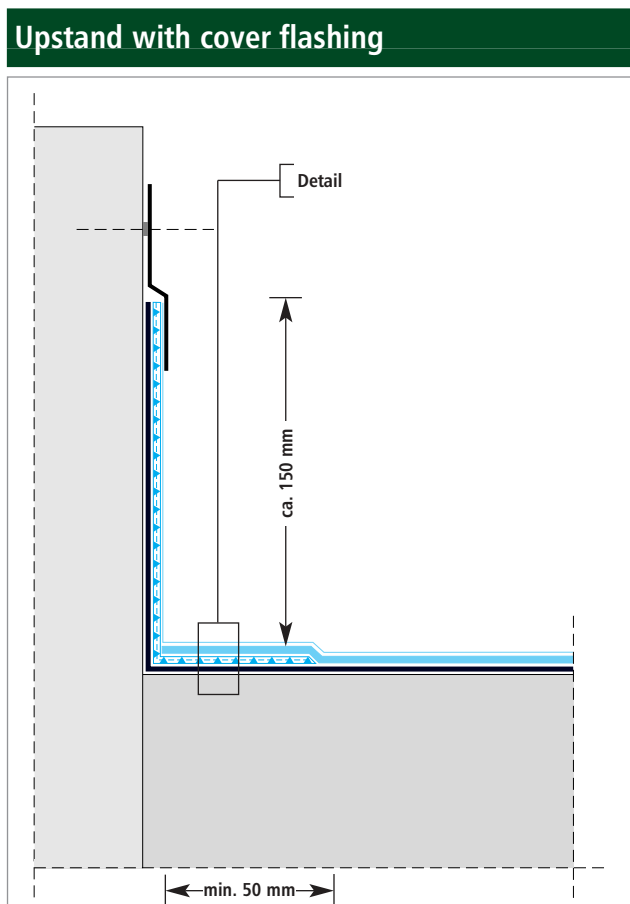
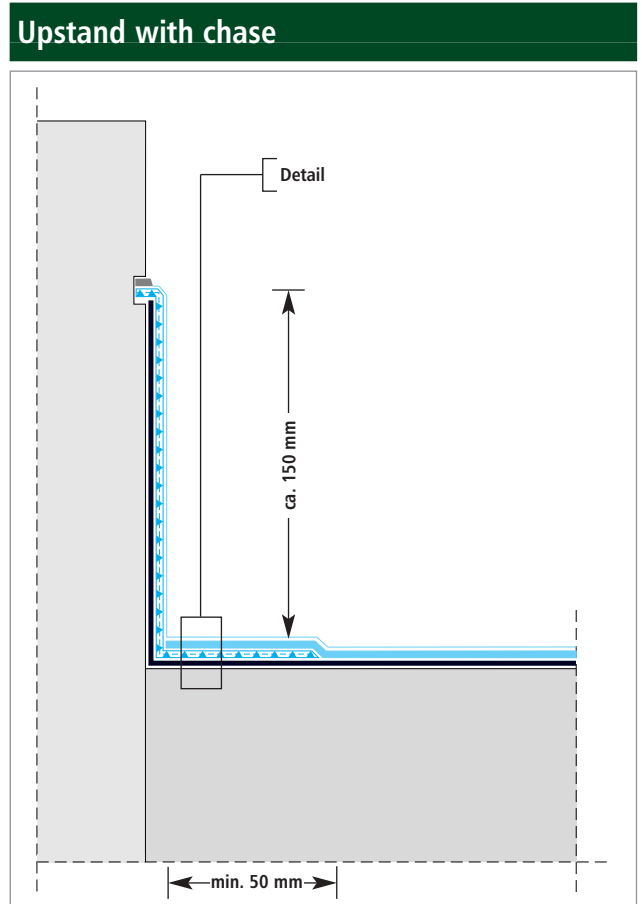
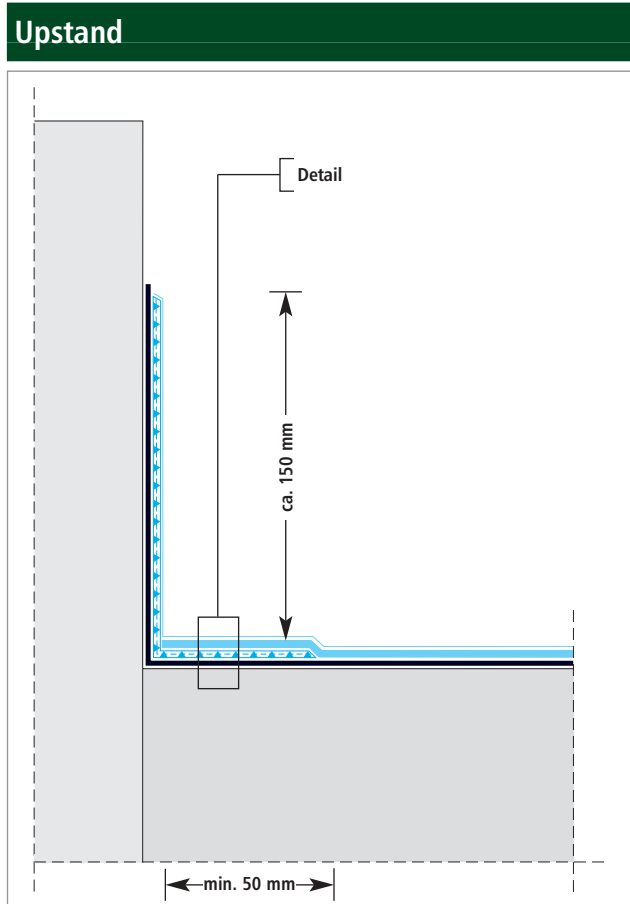

# Triflex BFS

# Sketch Details

Surface mounted detail

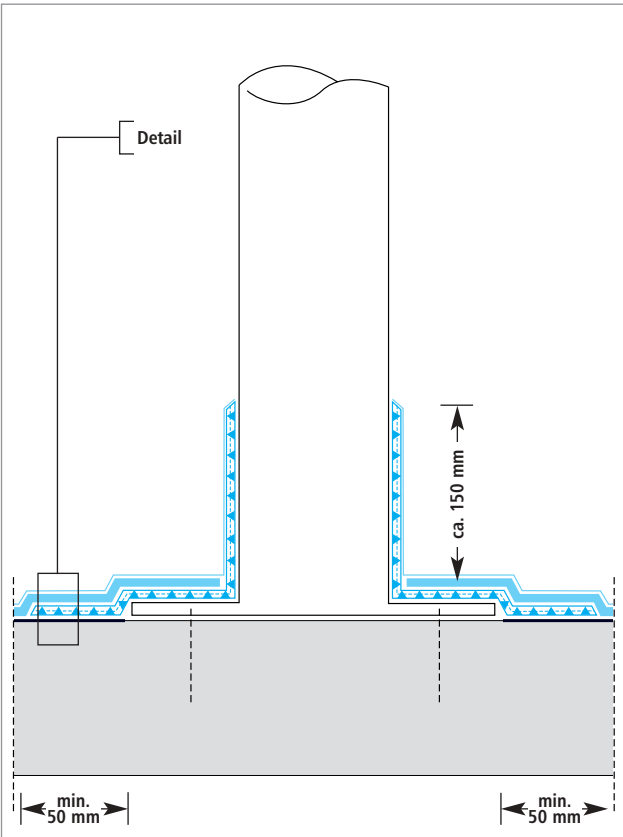

Gully

